



# INSERT MOUNT ELECTRIC HEATER STAND

Model No. KPE135-071

## OWNERS INSTRUCTION MANUAL

Congratulations on your purchase of a Kent Electric Heater Stand. Please read the following instructions carefully before use and retain for future reference.

### BEFORE FIRST USE

- Read and follow all the instructions below even if you feel you are familiar with the appliance.
- Remove the packing and make sure that the appliance is in tact. If in doubt do not use the appliance and contact the place of purchase.
- Do not leave packaging materials such as bags and staples within reach of children.
- Dispose of packaging carefully and with consideration for the environment.

For your convenience record the date you received the appliance on the warranty page of these instructions, and attach your proof of purchase. Retain this information in the event that a warranty service is required.

### IMPORTANT SAFETY INFORMATION

- Do not forget to fasten the head screw when a heater is fixed.
- When a heater is fixed to the stand, do not raise or lower the adjustable pole without the head screw fully tightened.
- The total height of the stand cannot be extended past 1710mm.
- Do not forget to fully tighten the height adjustment fastener.
- Do not place in an area with excessive wind load.
- Install on a flat, level surface only.
- Keep out of reach of children. Never leave children unsupervised with a heater on a stand.

Model	KPE135-071
Max. operating height	1710mm
Min. operating height	1350mm
Net Weight	8.84kg
Dimensions	410 $\varnothing$ $\times$ 1710 H mm
Max. support weight	5kg
Colour	Black

# ASSEMBLY INSTRUCTIONS

## Assembly

1. Open the packaging on a flat, dry, clean surface and ensure all parts are present. You will need a Phillips head screw driver.
2. Place the Base Cover (7) on top of the Base (8), lining up the tab hole. Put Lower Tube (6) into the hole, lining up the tab to fit.
3. Tip onto the side to access the bottom of the Base and connect together using the Washer (9) and L-Screw (10).
4. Stand the pole upright. Unscrew the two M6x12 (4) from the Middle Tube (5) and then install on top of the Lower Tube (6), refixing the screws.
5. Loosen the Outer Fastener (2) by twisting anti-clockwise. Pull out the Straight Tube (1) from the inside of the Upper Tube (3).
6. Tighten the Outer Fastener (2) by twisting clockwise. Install the Upper Tube (3) onto the Middle Tube (5), the same way as step 4.
7. Place the heater into position on the top of the adjustable pole. Insert 1 x M6x12 Screw (11) to fix the heater.

Tighten all fixings and insure installation is secure and firm. Check regularly and tighten.

## Parts List

No.	Part Name	Qty.
1	Straight Tube	1
2	Outer fastener	1
3	Upper Tube	1
4	Screw M6x12	4
5	Middle Tube	1
6	Lower Tube	1
7	Base Cover	1
8	Base	1
9	Washer	1
10	L-Screw	1
11	Screw M6x12 (for heater)	1

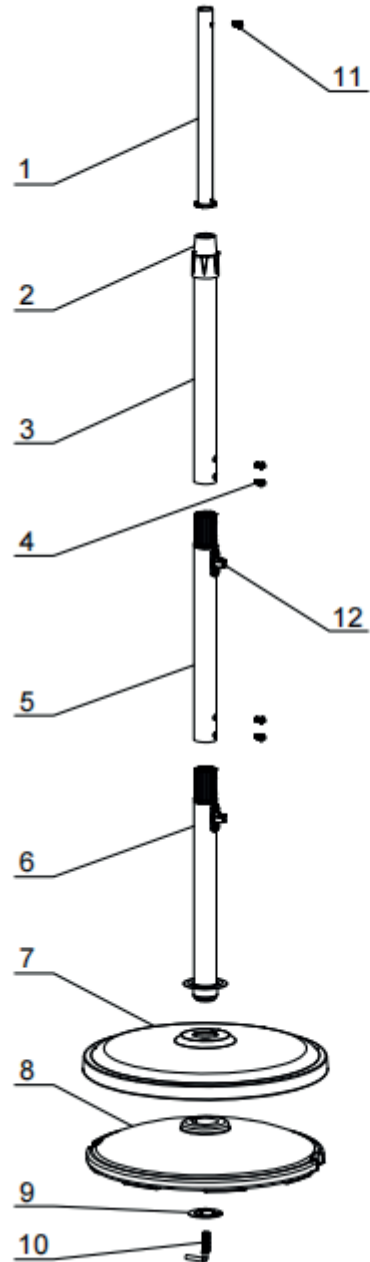

## **CLEANING AND CARE**

This product is made from engineered plastics and powder coated steel.

- Before each use, ensure the stand is not fully vertical and all connectors and screws are tightened.
- Wipe the appliance only with clean and lint - free cloth or a soft brush.
- Never use abrasive cleaners, scrubbing brushes and chemical cleaners for cleaning.
- If not used for extended periods, we recommend disassembling and storing in a dry, ventilated area.
- Dry fully before storage.

## WARRANTY GUIDELINES

1. Appliances will be free from defects in material and workmanship under normal use and service when installed and used in accordance with all applicable local laws and regulations.
2. If, during the warranty period, a product fails to operate properly due to defects in workmanship or materials, Aber Living will either, at its option, repair or replace the product without charge to the purchaser.

**The following circumstances or events are either deemed to be outside the scope of the general warranty policy as set out above, or will invalidate any warranty claim:**

- Normal customer maintenance, including yearly maintenance, routine maintenance, lubrication, etc.
- Damage caused by the continued use of a product after a fault has occurred.
- Accident, Act of God, nature or war, theft, abuse, misuse, negligence or neglect, including improper installation.
- Failure to operate or maintain the product in accordance with the owner's manual furnished with the product.
- Any alterations or modifications, including those affecting the product's performance, operation, safety, durability or changes in its intended use.
- Additional damage to parts or components due to consented use occurring after any of the above conditions.
- Incorrect installation or commissioning.

- Incorrect electrical installation or fitment to an inappropriate supply. Any electrical installation (fitting and wiring of new wall sockets etc) must be performed by a qualified electrician.
- The warranty applies only to the goods supplied and does not cover any other damage incurred.
- No agent, representative, dealer or employee of Aber Living or any other person has the authority to increase or alter the obligations of Aber Living under these warranties.

### **Proper Maintenance and Operation**

The original purchaser must exhibit reasonable care in the maintenance and operation of the product as explained in the maintenance section of the owner/operator's manual. When in doubt, the Retailer should be contacted by the original purchaser for advice.

### **WARRANTY CLAIM PROCEDURES**

Should a product failure occur then the original dealer should be contacted together with proof of purchase.

The following will apply to all products from date of purchase by the original consumer for use in a normal, domestic situation.

### **Kent Electric Heater Stand: 1 year from date of purchase.**

Products used for business purposes will carry a 90 day warranty.

For full warranty terms & conditions please refer to our website: **[www.kent.co.nz](http://www.kent.co.nz)**.

Kent® is a registered trademark of Aber Living, Hamilton, NZ.

**[www.Kent.co.nz](http://www.Kent.co.nz)**